

ARCHITECTURE
URBAN DESIGN
HERITAGE
INTERIORS
GRAPHICS

DIRECTORS &
NOMINATED ARCHITECTS
Keith E Cottier AM 2264
Glynn N Evans 2839
Michael Heenan 5264
Peter Ireland 6661
Reginald Smith 3312
Peter Stronach 3372

ASSOCIATE DIRECTORS
Stephen Black
Colin Janes
Kathlyn Loseby
Mark Louw
Kate Mountstephens
Andrew Parker
Deena Ridenour
Bernard J Rowe
John Suprun

SENIOR ASSOCIATES
William Clements
Nicola Middleton

ASSOCIATES
Nic Bailey
Michael Buchtmann
Ross Chalmers
Mark Corbet
Rob Doak
Belinda Falsone
John Gunnell
Jane Johnson
Sue Melosu
Scott Norton
Russell Parker
Tony Spragg
Daniel Staebe
Adrian Tarrant
Richard Terry
John Whittingham

SYDNEY OFFICE
79 Myrtle Street
Chippendale NSW 2008

AUSTRALIA
ph +61 2 9311 8222
fx +61 2 9311 8200

BRISBANE OFFICE
Lv3 Old Mineral House

2 Edward Street
Brisbane QLD 4000
AUSTRALIA

ph +61 7 300 42 300
fx +61 7 300 42 333

www.architectsajc.com

ALLEN JACK+COTTIER
Architects Pty Ltd
ABN 53 003 782 250



CIRCLING INNER MONGOLIA

27 March 2006

You could be forgiven for thinking Allen Jack+Cottier Director Michael Heenan has suddenly turned installation artist. In June last year he was seen driving around a 45km ring road in Inner Mongolia with Leigh Appleyard, Director of Appleyard Forrester Consulting Engineers Pty Ltd, and a flotilla of planners in tow. In the car with them were two moving digital cameras, a still camera and sound recording equipment, all operating at once.

In fact, the objective was to research mobility, and how mobility is perceived, for a new Allen Jack+Cottier masterplan for a 45 km ring road around Hohhot, the capital city of the Autonomous Region of Inner Mongolia.

The stronghold of Mongul leader Ghengis Khan and later his grandson Kublai Khan, Inner Mongolia and its capital are the gateway and transport hub for all traffic between China, the Russian Federation states, and Mongolia. This is a vast, harsh landscape: temperatures plummet from 26°C in summer to minus 20°C in winter, and the wind sweeps directly from Siberia onto the plains. Mobility and transport of every kind have always been crucial to the survival of this remote region, never more so than today.

Allen Jack+Cottier's designers are currently working on two major transport-related projects here: one is the ring road, which forms part of a visionary five-year urban plan. The second is a major transport 'hub', gateway and land port similar to an airport.

Heenan explains that the ring road is designed to accommodate rapid growth in Hohhot over the next 20 years. "In an act of great foresight, the city authorities put the road in first, so that the city grows out to meet the ring road. Running the full circle of the ring road are good quality kerbs and gutters, seven rows of mature trees, dedicated lanes for public transport and bikeways, and extensive landscaping," he said.

Planning for the new transport hub or 'landport' and gateway at Heishantou (approximately 1500 km northeast of Hohot) also bears witness to the vision of Inner Mongolia's bureaucrats. Essentially an airport terminal for trucks, cars and trains but not airplanes, the 'land port' was designed by Allen Jack+Cottier, in association with Appleyard Forrest. It comprises a terminal building, separate processing areas for domestic and commercial vehicles, trains, and a passenger terminal with a gross site area of approximately 6 sq km.

The hub will be capable of scanning passenger passports, as well as X-raying and weighing semi-trailers and inspection trains. Allen Jack+Cottier's design draws on the repository of local artwork, customs and dress in terms of colour and shapes, clearly differentiating the land port from its vast, harsh surroundings, and conveying a sense of arrival and welcome to the weary traveller.

For further information and images of the project:

Rosemary Luker

Media Relations

+61 (0) 2 9518 9544

communications@architectsajc.com

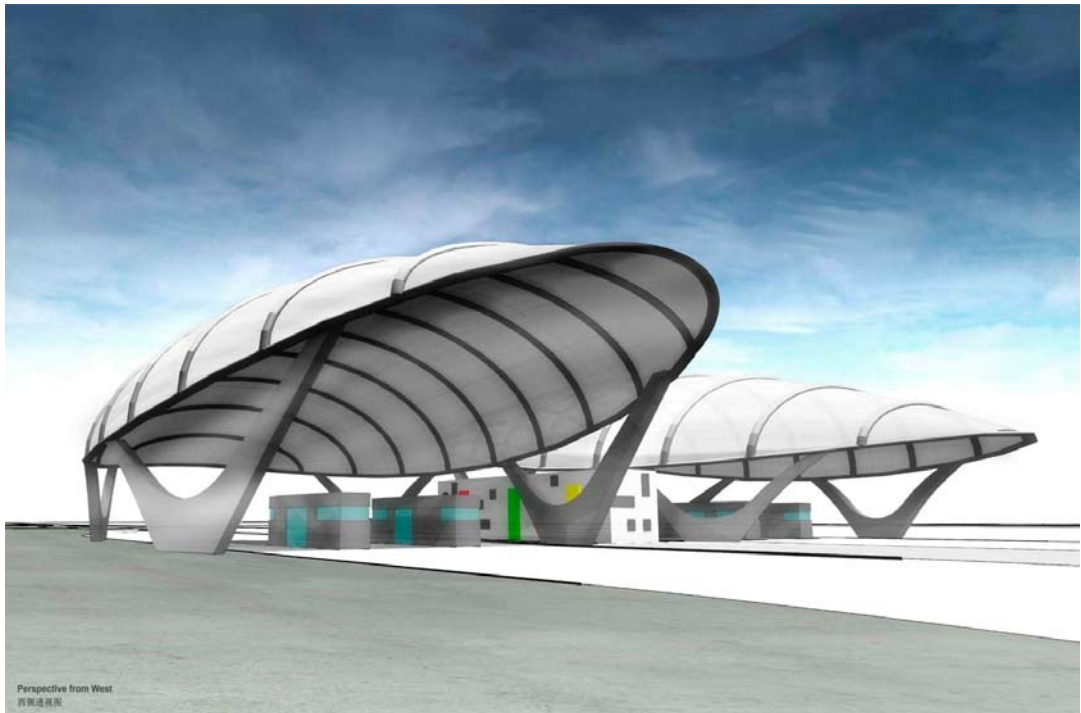

Perspective from West
西側透視